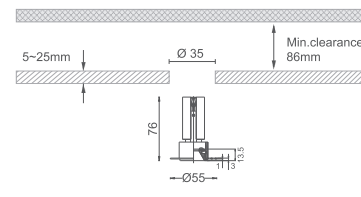
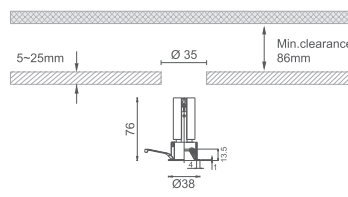
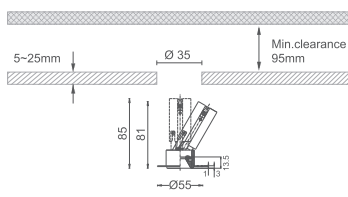
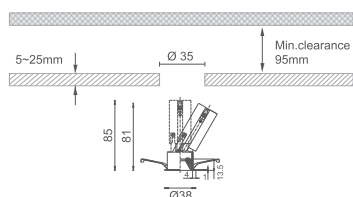

MILAN R-1.1
MILAN R-1.2

TR - Trim Adjustable
TS - Trimless Adjustable
TR - Trim Fixed
TS - Trimless Fixed
MILAN R-I
EN

The CREE LED 4.5W/6W Architectural Lighting offers reliable and efficient lighting for diverse architectural applications. With LED power ranging from 4.5W to 6W and system power from 6W to 8W, it delivers LED outputs of 410lm to 532lm and system outputs of 268lm to 375lm. Beam angles of 15°, 24°, and 36° ensure versatile light distribution. Featuring a 3000K CCT and a CRI above 90, it provides excellent color rendering for vivid illumination. The standard CCT options span 2700K to 6000K, and control systems include On/Off, DALI, 0/1-10V, and TRIAC. Available in white or black front rings, with color reflectors in white, black, silver, or black chrome. IP20 features E01 honeycomb louvers, while IP54 supports E02, E03, and E04 lens options, ensuring durability and adaptability for varied needs.

IT

L'illuminazione architettonica CREE LED 4,5W/6W offre un'illuminazione affidabile ed efficiente per diverse applicazioni architettoniche. Con una potenza LED compresa tra 4,5 W e 6 W e una potenza di sistema compresa tra 6 W e 8 W, offre uscite LED da 410 lm a 532 lm e uscite di sistema da 268 lm a 375 lm. Gli angoli di emissione di 15°, 24° e 36° garantiscono una distribuzione della luce versatile. Dotato di un CCT 3000K e un CRI superiore a 90, fornisce un'eccellente resa cromatica per un'illuminazione vivida. Le opzioni CCT standard vanno da 2700K a 6000K e i sistemi di controllo includono On/Off, DALI, 0/1-10V e TRIAC. Disponibile con anelli frontali bianchi o neri, con catarifrangenti colorati in bianco, nero, argento o cromo nero. IP20 è dotato di feritoie a nido d'ape E01, mentre IP54 supporta le opzioni di lenti E02, E03 ed E04, garantendo durata e adattabilità per le diverse esigenze.

Reference: System Power - Output Lumen - Delivered Lumen - Beam Angle

MILAN R-1.1	A046	6W - 410lm - 268lm - 15°	A047	6W - 410lm - 280lm - 24°	A048	6W - 410lm - 317lm - 36°
	A049	8W - 532lm - 310lm - 15°	A050	8W - 532lm - 331lm - 24°	A051	8W - 532lm - 375lm - 36°
MILAN R-1.2	A052	6W - 410lm - 335lm - 15°	A053	6W - 410lm - 54lm - 36°	A054	6W - 410lm - 332lm - 24°
	A056	8W - 532lm - 420lm - 15°	A057	8W - 532lm - 398lm - 24°	A058	8W - 532lm - 412lm - 36°

Mode	Finish	CCT/CRI		IP	Dim		Emergency	Colour (Reflector)	
TR Trim Version	W - WHITE	K1 - 2700K /90	K2 - 3000K /90	1 - IP20	A - On/Off	B - DALI	Y- Yes	W - White	B - Black
TS Trimless Version	B - BLACK	K3 - 3500K /90	K4 - 4000K /90	2 - IP54	C - 0/1-10v	D - TRIAC	N- No	S - Silver	BC - Black Chrome
		K5 - 5000K /90	K6 - 2700-6000K /90		E - BLUETOOTH H	F - ZIGBEE			
					G - CASAMBI				

Code Example

A001 TA W K11 Δ Y

Enter Your Code:

CODE MODE FINISH CCT IP DIM EMERGENCY

5.5W/15°/3000K/Ra90

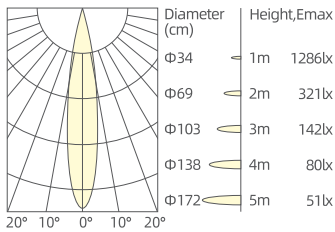

5.5W/24°/3000K/Ra90

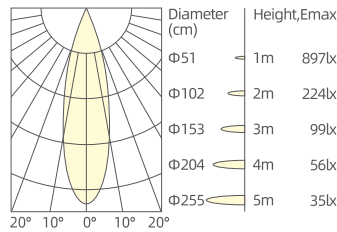

5.5W/36°/3000K/Ra90

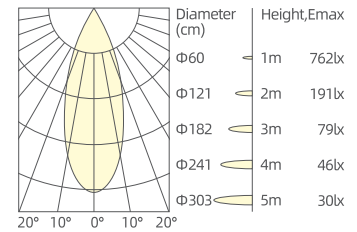

7W/15°/3000K/Ra90

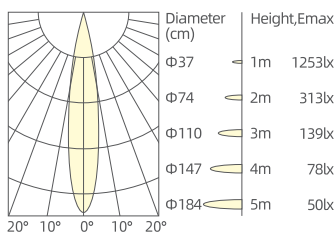

7W/24°/3000K/Ra90

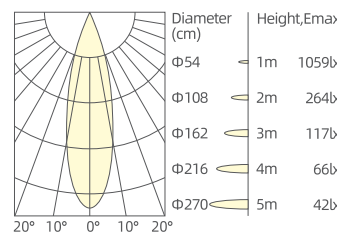

7W/36°/3000K/Ra90

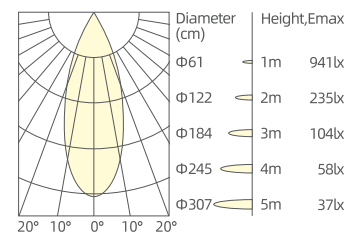

Optical Accessories

- OR01
Honeycomb Louver
- OR02
Spread Lens
- OR03
Diffusion Lens
- OR04
Clear Lens

Colour(Reflector)

- White
- Black
- Silver
- Black chrome