

7W- 12W

MILAN R-4.1

12.5W- 20W

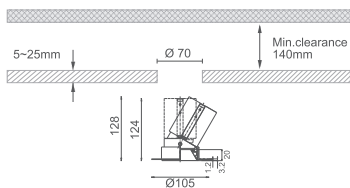
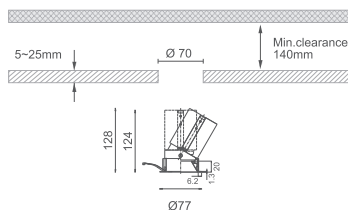
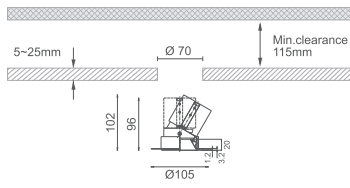
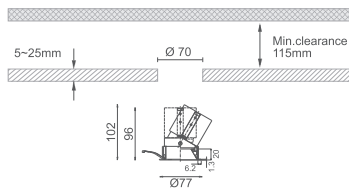

TR - Trim Adjustable

TS - Trimless Adjustable

TR - Trim Adjustable

TS - Trimless Adjustable

7W- 12W

MILAN R-4.2

12.5W- 20W

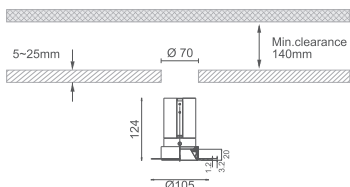
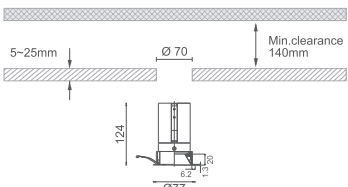
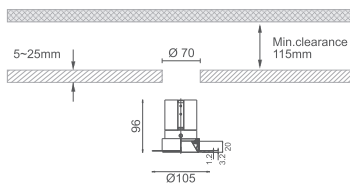
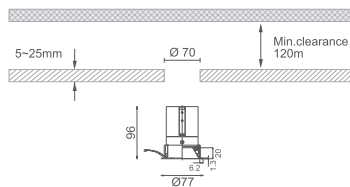

TR - Trim Fixed

TS - Trimless Fixed

TR - Trim Fixed

TS - Trimless Fixed

MILAN R-IV

EN

This LED 8.5W/10W (CITIZEN-LED) architectural lighting fixture is crafted for versatile and efficient illumination. With LED power between 6W and 10W and system power from 7W to 11.5W, it achieves LED output from 484lm to 1320lm and system output ranging from 352lm to 1062lm. Beam angles include 6°, 10°, 15°, 24°, 36°, 45°, and 55°, and it offers a 3000K color temperature (CCT) with a CRI >90 for accurate color representation. The front ring is available in white and black finishes, with reflector options in white, black, silver, black chrome, grey, golden, bronze, and wood. IP ratings are IP20 and IP54 with a CCT range of 2700K to 6000K. Control systems supported include on/off, DALI, 0/1-10V, and Triac. Optical accessories such as the E01 honeycomb louver (IP20), E02 spread lens, E03 diffusion lens, and E04 clear lens can achieve IP54 protection.

IT

Questo apparecchio di illuminazione architettonica a LED 8,5W/10W (CITIZEN-LED) è realizzato per un'illuminazione versatile ed efficiente. Con una potenza dei LED compresa tra 6 W e 10 W e una potenza del sistema compresa tra 7 W e 11,5 W, raggiunge un'uscita LED da 484 lm a 1320 lm e un'uscita del sistema compresa tra 352 lm e 1062 lm. Gli angoli del fascio includono 6°, 10°, 15°, 24°, 36°, 45° e 55° e offre una temperatura di colore (CCT) di 3000K con un CRI >90 per una rappresentazione accurata dei colori. L'anello frontale è disponibile nelle finiture bianco e nero, con opzioni di riflettore in bianco, nero, argento, cromo nero, grigio, oro, bronzo e legno. I gradi di protezione IP sono IP20 e IP54 con una gamma CCT da 2700K a 6000K. I sistemi di controllo supportati includono on/off, DALI, 0/1-10V e Triac. Gli accessori ottici come la feritoia a nido d'ape E01 (IP20), la lente di diffusione E02, la lente di diffusione E03 e la lente trasparente E04 possono raggiungere la protezione IP54.

Reference: System Power - Output Lumen - Delivered Lumen - Beam Angle

Adjustable 4.1	A090	7W - 484lm - 352lm - 6°	A091	9W - 951lm - 669lm - 15°	A092	10W - 1067lm - 907lm - 24°	A093	10W - 1067lm - 944lm - 36°
	A094	10W - 1067lm - 931lm - 45°	A095	10W - 1067lm - 932lm - 55°	A096	11W - 792lm - 540lm - 10°	A097	10.5W - 1087lm - 724lm - 15°
	A098	11.5W - 1320lm - 1032lm - 24°	A099	11.5W - 1320lm - 1080lm - 36°	A100	11.5W - 1320lm - 1089lm - 45°	A101	11.5W - 1320lm - 1064lm - 55°
	A102	12W - 946lm - 654lm - 10°						
	A104	12.5W - 1087lm - 858lm - 15°	A105	14W - 1650lm - 1263lm - 24°	A106	14W - 1650lm - 1321lm - 36°	A107	14W - 1650lm - 1310lm - 45°
	A108	14W - 1650lm - 1312lm - 55°	A109	14.5W - 946lm - 697lm - 10°	A110	20W - 1926lm - 1207lm - 15°	A111	20W - 2343lm - 1741lm - 24°
	A112	20W - 2343lm - 1869lm - 36°	A113	20W - 2343lm - 1850lm - 45°	A114	20W - 2343lm - 1821lm - 55°		
Fixed 4.2	A090	7W - 484lm - 352lm - 6°	A091	9W - 951lm - 669lm - 15°	A092	10W - 1067lm - 907lm - 24°	A093	10W - 1067lm - 931lm - 45°
	A094	10W - 1067lm - 932lm - 55°	A095	10W - 1067lm - 944lm - 36°	A096	10.5W - 1087lm - 724lm - 15°	A097	11W - 792lm - 540lm - 10°
	A098	11.5W - 1320lm - 1032lm - 24°	A099	11.5W - 1320lm - 1064lm - 55°	A100	11.5W - 1320lm - 1080lm - 36°	A101	11.5W - 1320lm - 1089lm - 45°
	A102	12W - 946lm - 654lm - 10°	A103	10W - 1067lm - 907lm - 24°				
	A104	12.5W - 1087lm - 858lm - 15°	A105	14W - 1650lm - 1263lm - 24°	A106	14W - 1650lm - 1310lm - 45°	A107	14W - 1650lm - 1312lm - 55°
	A108	14W - 1650lm - 1321lm - 36°	A109	14.5W - 946lm - 697lm - 10°	A110	20W - 1926lm - 1207lm - 15°	A111	20W - 2343lm - 1741lm - 24°
	A112	20W - 2343lm - 1850lm - 45°	A113	20W - 2343lm - 1869lm - 36°	A114	20W - 2343lm - 1821lm - 55°		

Mode	Finish	CCT/CRI		IP	Dim		Emergency	Colour (Reflector)	
TR Trim Version	W - WHITE	K1 - 2700K /90	K2 - 3000K /90	1 - IP20	A - On/Off	B - DALI	Y- Yes	W - WHITE	B - BLACK
TS Trimless Version	B - BLACK	K3 - 3500K /90	K4 - 4000K /90	2 - IP54	C - 0/1-10v	D - TRIAC	N- No	S - SILVER	BC - BLACK CHROME
		K5 - 5000K /90	K6 - 2700-6000K /90		E - BLUETOOTH H	F - ZIGBEE		G - GREY	GO - GOLDEN
		K7 - 1800-4000K /90	K8 - DTW-1800-3000K /90	G - CASAMBI		BR - BRONZE	WD - WOOD		
		K9 - RGBCW /90							

Code Example

A001 TA W K1 1 A Y

Enter Your Code:

CODE MODE FINISH CCT IP DIM EMERGENCY

Optical Accessories



Colour(Reflector)



9W/15°/3000K/Ra90

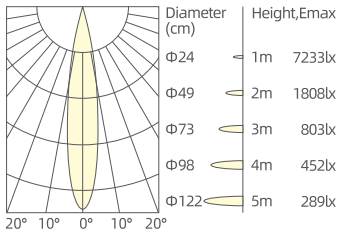

10W/24°/3000K/Ra90

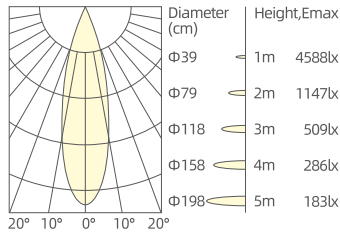

10W/36°/3000K/Ra90

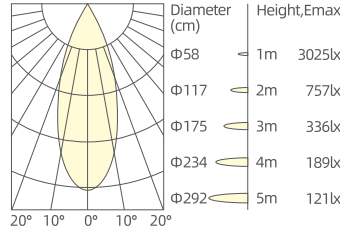

10W/45°/3000K/Ra90

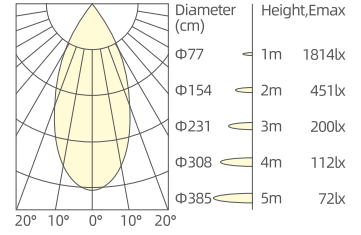

10W/55°/3000K/Ra90

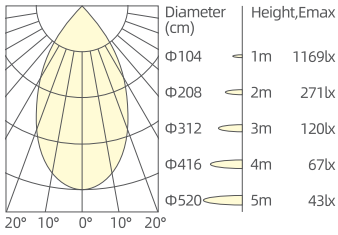

11W/10°/3000K/Ra90

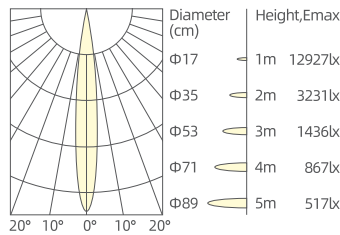

12.5W/15°/3000K/Ra90

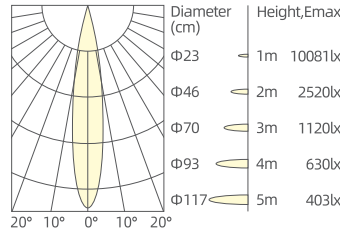

14.5W/10°/3000K/Ra90

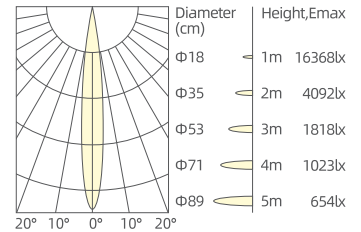

14W/24°/3000K/Ra90

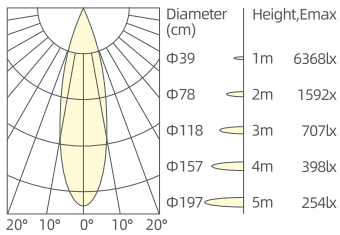

14W/36°/3000K/Ra90

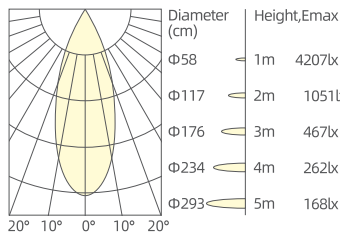

14W/45°/3000K/Ra90

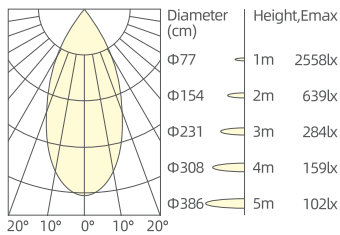

14W/55°/3000K/Ra90

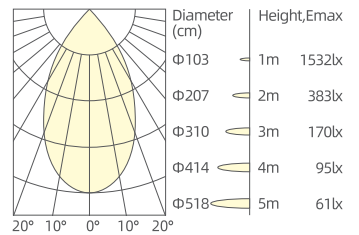

20W/15°/3000K/Ra90

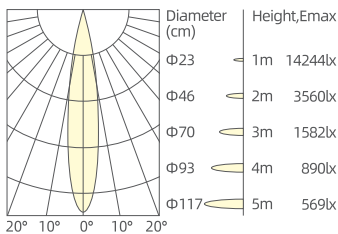

20W/24°/3000K/Ra90

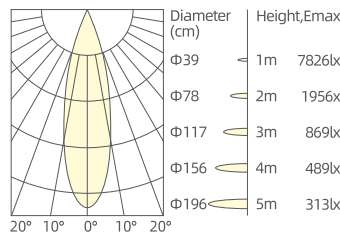

20W/36°/3000K/Ra90

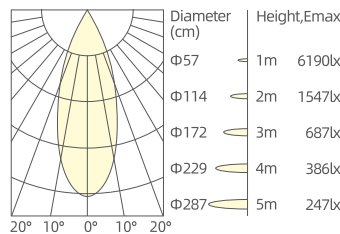

20W/45°/3000K/Ra90

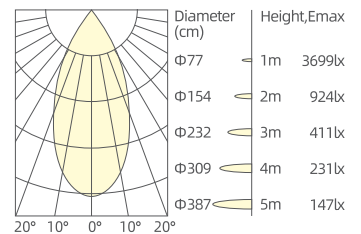

20W/55°/3000K/Ra90

