

MILAN R-8.1

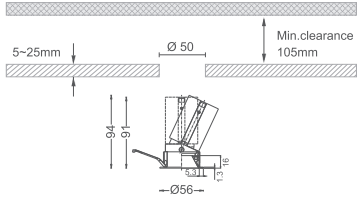

TR - Trim Adjustable

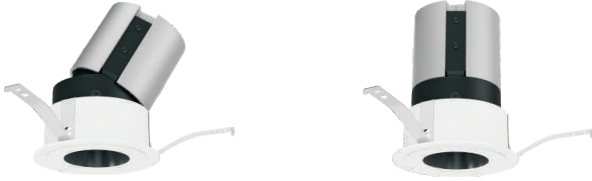
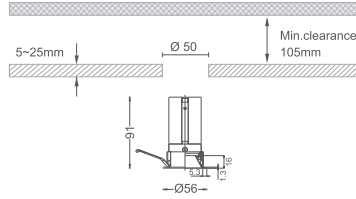

TR - Trim Fixed

MILAN R-8.2

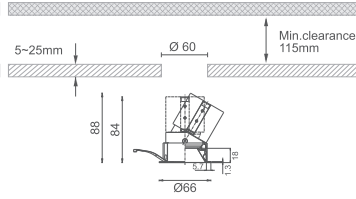

TR - Trim Adjustable

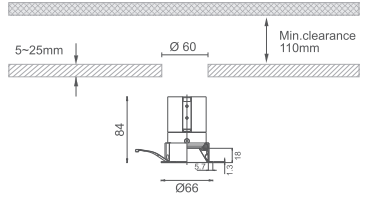

TR - Trim Fixed

MILAN R-8.3

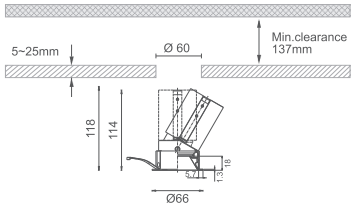

TR - Trim Adjustable

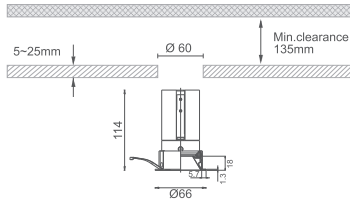

TR - Trim Fixed

MILAN R-8.4

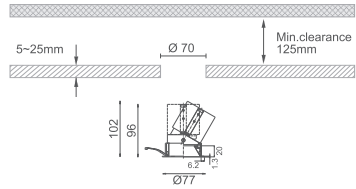

TR - Trim Adjustable

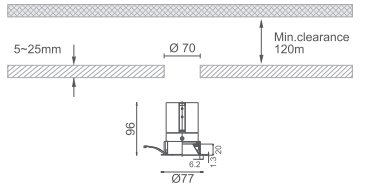

TR - Trim Fixed

MILAN R-8.5

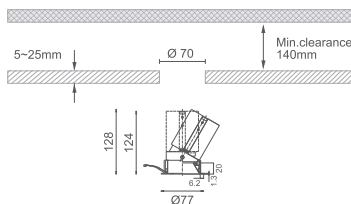

TR - Trim Adjustable

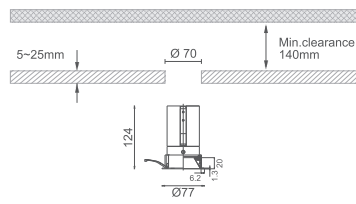

TR - Trim Fixed

MILAN R-VIII**EN**

The LED 4.5W/6.5W/8W (Citizen LED) Architectural Lighting fixture offers efficient, precision lighting tailored for architectural spaces. With LED power ranging from 6.5W to 8W and system power between 7W and 9W, it provides an LED output of 660lm to 815lm and a system output from 350lm to 500lm. Beam angle options include 15°, 24°, 36°, and 45°, and the 3000K color temperature with a CRI > 90 ensures vibrant, true-to-life colors with an extended range of 2700K to 6000K. The drive range spans 34V at 200mA to 32V at 250mA, and IP ratings of 20 and 54 make it suitable for varied environments. The fixture includes control options for on/off, DALI, 0/1-10V, and Triac. Available reflector colors include black, with white and black front ring finishes. For added versatility, E01 honeycomb louver (IP20) and E02 spread, E03 diffusion, and E04 clear lenses (IP54) provide protection and lighting customization.

IT

L'apparecchio di illuminazione architettonica a LED 4,5W/6,5W/8W (Citizen LED) offre un'illuminazione efficiente e precisa su misura per gli spazi architettonici. Con una potenza LED compresa tra 6,5 W e 8 W e una potenza di sistema compresa tra 7 W e 9 W, fornisce un'uscita LED da 660 lm a 815 lm e un'uscita di sistema da 350 lm a 500 lm. Le opzioni di angolo del fascio includono 15°, 24°, 36° e 45° e la temperatura di colore 3000K con un CRI > 90 garantisce colori vivaci e realistici con una gamma estesa da 2700K a 6000K. La gamma di azionamenti va da 34 V a 200 mA a 32 V a 250 mA e i gradi di protezione IP di 20 e 54 lo rendono adatto a vari ambienti. L'apparecchio include opzioni di controllo per on/off, DALI, 0/1-10V e Triac. I colori disponibili del riflettore includono il nero, con finiture bianche e nere dell'anello frontale. Per una maggiore versatilità, la feritoia a nido d'ape E01 (IP20) e la diffusione E02, la diffusione E03 e le lenti trasparenti E04 (IP54) forniscono protezione e personalizzazione dell'illuminazione.

Reference: System Power - Output Lumen - Delivered Lumen - Beam Angle

MILAN R-8.1	A188	7W - 660lm - 350lm - 15°	A189	7W - 652lm - 447lm - 24°	A190	7W - 652lm - 469lm - 36°	A191	7W - 652lm - 427lm - 45°
	A192	9W - 792lm - 450lm - 15°	A193	9W - 815lm - 508lm - 24°	A194	9W - 815lm - 537lm - 36°	A195	9W - 815lm - 500lm - 45°
MILAN R-8.2	A196	7W - 484lm - 224lm - 8°	A197	7W - 652lm - 374lm - 15°	A198	8W - 922lm - 466lm - 24°	A199	8W - 922lm - 522lm - 36°
	A200	8W - 922lm - 501lm - 45°	A201	8W - 922lm - 491lm - 55°	A202	9W - 815lm - 432lm - 15°	A203	10W - 1067lm - 570lm - 24°
	A204	10W - 1067lm - 631lm - 36°	A205	10W - 1067lm - 621lm - 45°	A206	10W - 1067lm - 594lm - 55°		
MILAN R-8.3	A207	10.5W - 951lm - 479lm - 15°	A208	11.5W - 1320lm - 632lm - 24°	A209	11.5W - 1320lm - 663lm - 55°	A210	11.5W - 1320lm - 678lm - 45°
	A211	11.5W - 1320lm - 732lm - 36°	A212	12.5W - 1087lm - 521lm - 15°	A213	14W - 1650lm - 777lm - 24°	A214	14W - 1650lm - 856lm - 36°
	A215	14W - 1650lm - 827lm - 45°	A216	14W - 1650lm - 811lm - 55°				
MILAN R-8.4	A217	7W - 484lm - 264lm - 6°	A218	9W - 951lm - 501lm - 15°	A219	10W - 1067lm - 680lm - 24°	A220	10W - 1067lm - 708lm - 36°
	A221	10W - 1067lm - 702lm - 45°	A222	10W - 1067lm - 699lm - 55°	A223	10.5W - 1087lm - 543lm - 15°	A224	11W - 792lm - 405lm - 10°
	A225	11.5W - 1320lm - 774lm - 24°	A226	11.5W - 1320lm - 810lm - 36°	A227	11.5W - 1320lm - 816lm - 45°	A228	11.5W - 1320lm - 798lm - 55°
	A229	12W - 946lm - 490lm - 10°						
MILAN R-8.5	A230	12.5W - 1087lm - 643lm - 15°	A231	14W - 1650lm - 1650lm - 24°	A232	14W - 1650lm - 1650lm - 36°	A233	14W - 1650lm - 1650lm - 45°
	A234	14W - 1650lm - 1650lm - 55°	A235	14.5W - 946lm - 522lm - 10°	A236	20W - 1926lm - 1926lm - 15°	A237	20W - 2343lm - 2343lm - 24°
	A238	20W - 2343lm - 2343lm - 36°	A239	20W - 2343lm - 2343lm - 45°	A240	20W - 2343lm - 2343lm - 55°		

Mode	Finish	CCT/CRI		IP	Dim		Emergency	Colour (Reflector)
TR Trim Version	W - WHITE	K1 - 2700K /90	K2 - 3000K /90	1 - IP20	A - On/Off	B - DALI	Y- Yes	B - BLACK
	B - BLACK	K3 - 3500K /90	K4 - 4000K /90	2 - IP54	C - 0/1-10v	D - TRIAC	N- No	
		K5 - 5000K /90	K6 - 2700-6000K /90		E - BLUETOOTH	F - ZIGBEE		
		K7 - 1800-4000K /90	K8 - DTW-1800-3000K /90		G - CASAMBI			

Code Example

A001 TA W K11 A Y

Enter Your Code:

CODE MODE FINISH CCT IP DIM EMERGENCY

Optical Accessories

- OR01**
 Honeycomb Louver
- OR02**
 Spread Lens
- OR03**
 Diffusion Lens
- OR04**
 Clear Lens

Colour(Reflector)



Black

7W/15°/3000K/Ra90

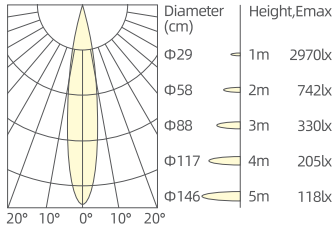

7W/24°/3000K/Ra90

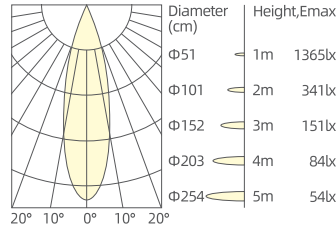

7W/36°/3000K/Ra90

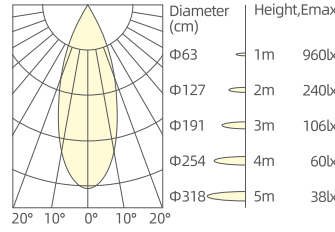

7W/45°/3000K/Ra90

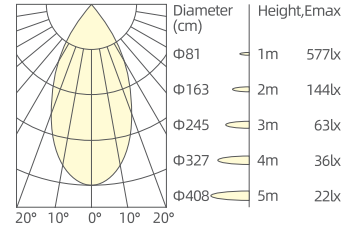

9W/15°/3000K/Ra90

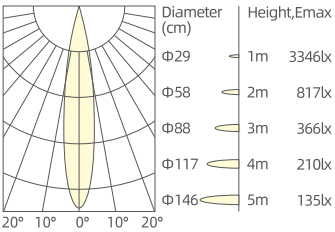

9W/24°/3000K/Ra90

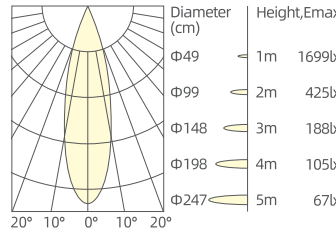

9W/36°/3000K/Ra90

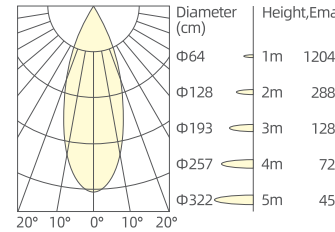

9W/45°/3000K/Ra90

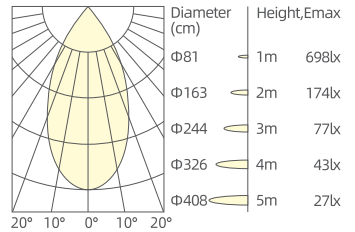

10W/24°/3000K/Ra90

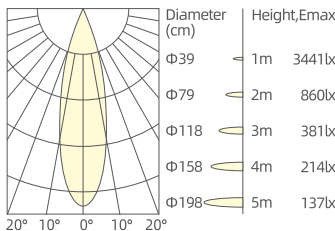

10W/36°/3000K/Ra90

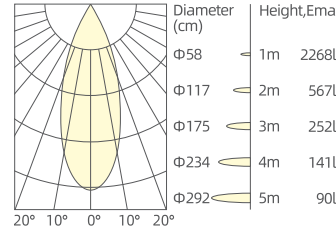

10W/45°/3000K/Ra90

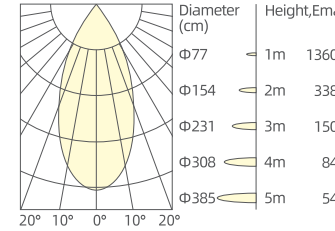

10W/55°/3000K/Ra90

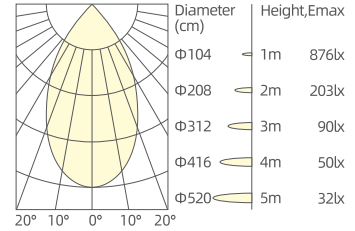

14W/24°/3000K/Ra90

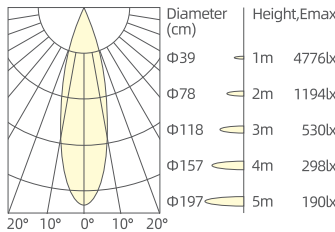

14W/36°/3000K/Ra90

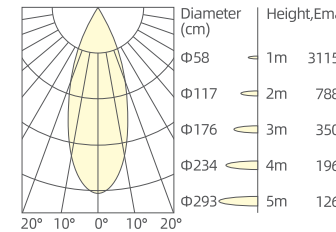

14W/45°/3000K/Ra90

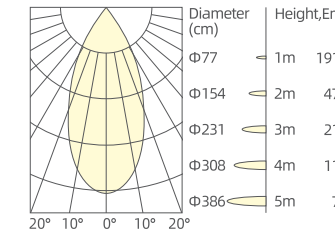

14W/55°/3000K/Ra90

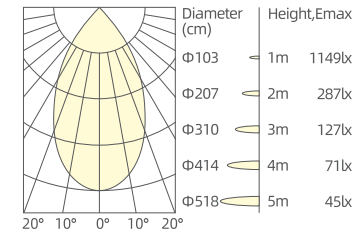

20W/15°/3000K/Ra90

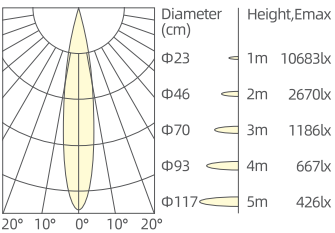

20W/24°/3000K/Ra90

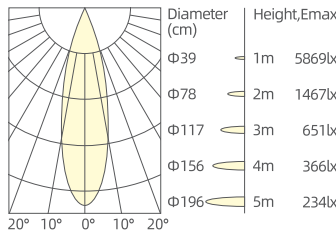

20W/36°/3000K/Ra90

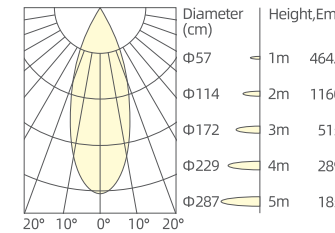

20W/45°/3000K/Ra90

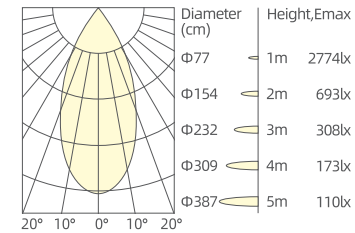

20W/55°/3000K/Ra90

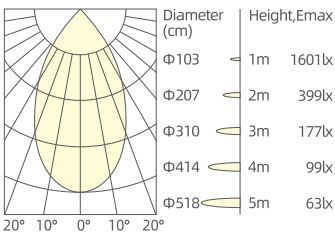

12.5W/15°/3000K/Ra90

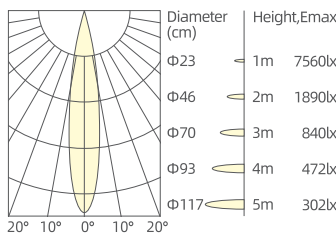

11W/10°/3000K/Ra90

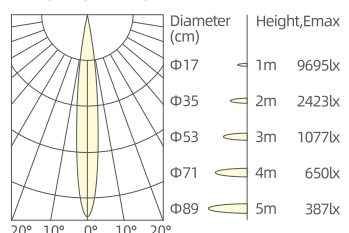

9W/15°/3000K/Ra90

